



ALFRESCO PURE FILTER TAP

(Mains Pressure Installations Only)

INSTALLATION INSTRUCTIONS

PRODUCT #

BATCH #

ATTENTION PLUMBER

To ensure the optimum performance and customer satisfaction please adhere to the following:

- Flush out all pipe work prior to installation
- Installation shall be in accordance with the AS/NZS3500 series of standards.
The maximum operating pressure within any building should not exceed 500kpa.
Pressure above 500kpa can cause damage from water hammer, reducing life of appliances, taps and fittings and cause excessive noise in the plumbing system.
- Pressure over 1000kPa will require a limiting valve.
- Inline filters must be installed on both hot and cold supplies.

TECHNICAL DATA

- Minimum Water pressure for satisfactory operation: 200kPa
- Maximum Water pressure: 500KPa

Please leave this form with the product once installed.

For full warranty terms and conditions, please see the warranty card enclosed with this product or visit www.greenstapware.com/warranty-and-care/

Distributed by: Greens Global Limited
PO Box 5055, Hamilton, 3200
22 The Boulevard, Te Rapa, Hamilton 3200
Phone: 07 849 0109, Fax: 07 849 0540
Website: www.greenstapware.com
Email: nzsales@greenstapware.com
Service Hotline: 0800 655 455

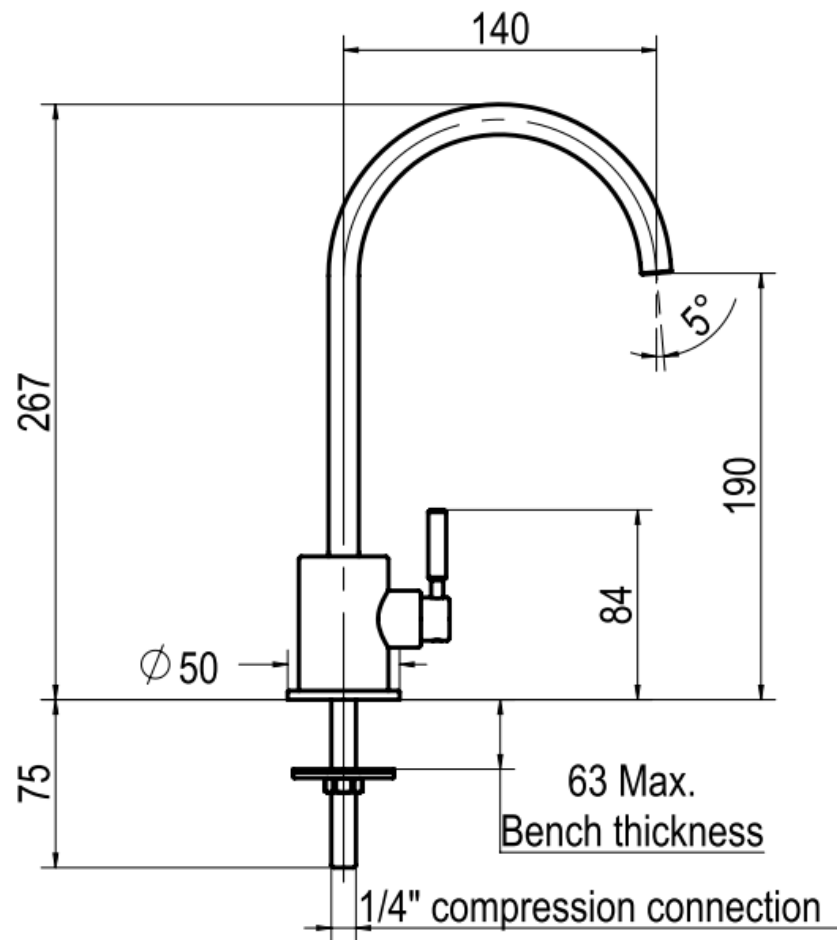

INSTALLATION INSTRUCTIONS

Note: Fits maximum bench thickness of 60mm

Cut a mounting hole 12mm diameter in the bench surface.

1. Flush pipe work to ensure it is free from debris.
2. Cut a mounting hole as per cut-out above in the desired position for the faucet.
3. Remove mounting nut, steel washer and rubber washer from filter tap.
4. Position in bench top ensuring the base seal is in place.
5. From underneath the bench install the rubber washer, steel washer and mounting nut.
6. Connect to cold water supply (See installations for water filter systems - Not included).
 - a. 1/4" compression fitting is required. (Not included.)
7. Turn on water supply and check for leaks.