



## ASTRO II, ROCCO RAIL SHOWER

(Mains Pressure Installations)

### INSTALLATION INSTRUCTIONS

PRODUCT #

BATCH #

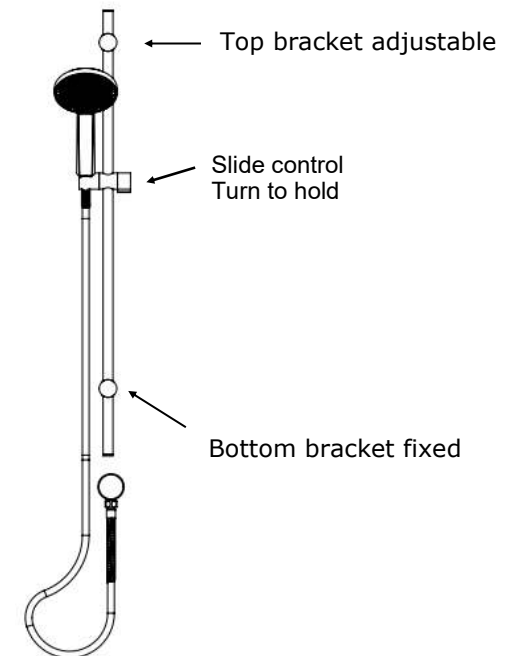
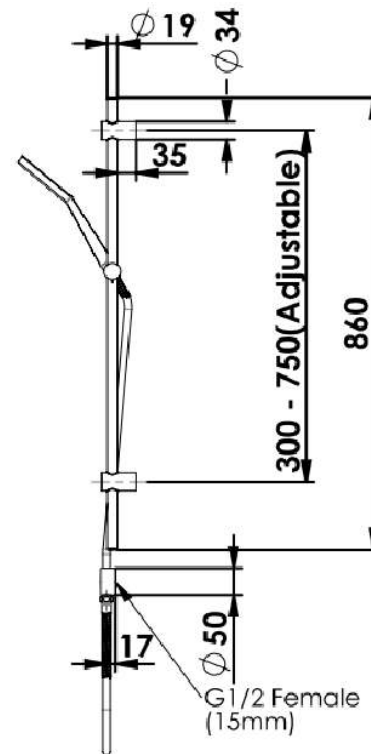

Please contact country of purchase .

**Distributed by: Greens Global AUS PTY LTD**  
36 Naxos Way, Keysborough VIC 3173  
Phone: 1800 244 487 Fax: 1800 244 212  
Email: aussales@greenstapware.com  
Website: www.greenstapware.com  
**Service Hotline: 1800 244 992**

**Distributed by: Greens Global Limited**  
PO Box 5055, Hamilton, 3200  
22 The Boulevard, Te Rapa, Hamilton 3200  
Phone: 07 849 0109, Fax: 07 849 0540  
Website: www.greenstapware.com  
Email: nzsales@greenstapware.com  
**Service Hotline: 0800 655 455**

#### Technical Data

- **Suitable for use with high pressure water supply only.**  
Not suitable for gravity-fed water heaters, low and unequal pressure networks.
- Minimum Water pressure: 150kpa.
- Maximum water pressure: 500kpa.
- Pressure over 500kpa will require a limiting valve.
- Installation shall be in accordance with the AS/NZS3500 series of standards.
- Flow rate of 3 star 9 l/m has been rated under the Australian & NZ Water Efficiency Labeling Scheme (WELS).

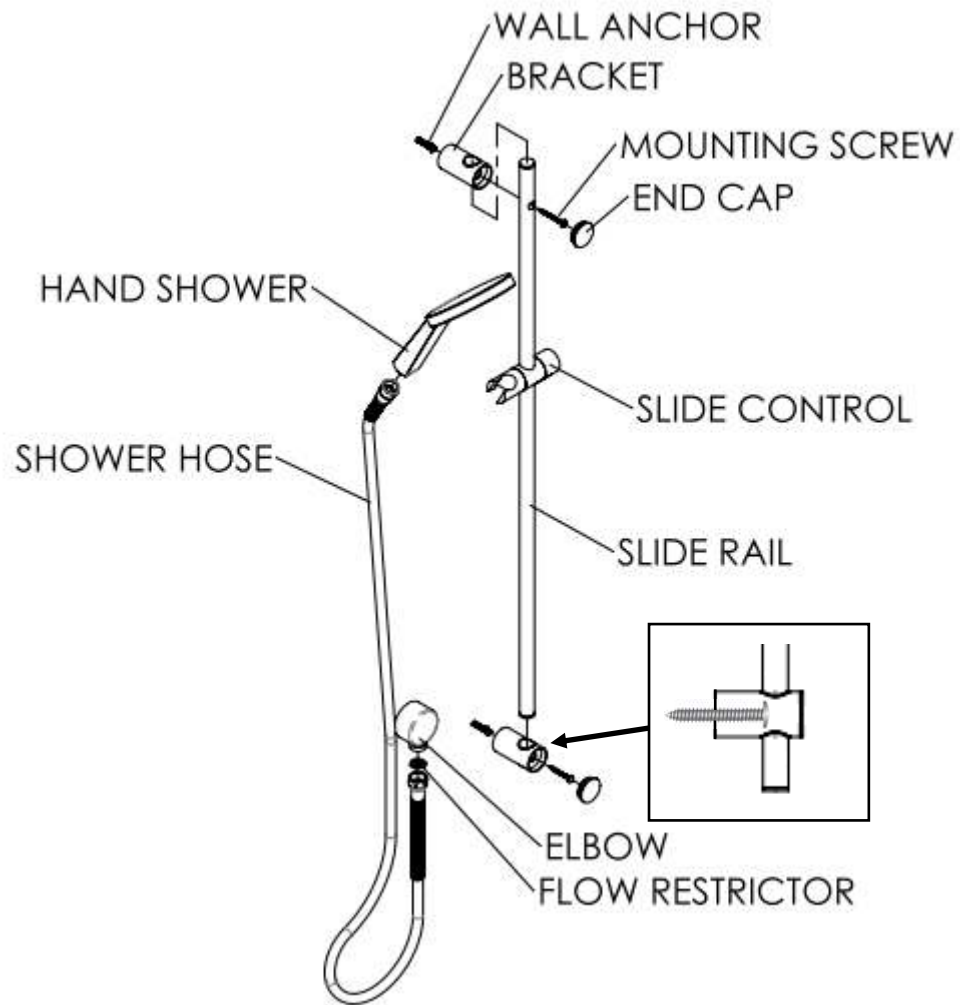

## INSTALLATION INSTRUCTIONS

### Install Top Bracket:

1. Mark out bracket positions on wall with **MAX 750mm centres**.
  - a. Top bracket is adjustable to 750mm centres.
  - b. Check they are straight on wall.
2. Remove top bracket from rail and remove end cap.
3. Install bracket to wall and re-fit the end cap.
  - a. Silicone sealant is recommended to seal the bracket mounts.
  - b. Wall anchors are provided for masonry walls.

### Install Rail:

1. Remove bottom bracket cap.
2. **Align bottom bracket with hole in rail.**
  - a. **Note: Smaller hole in rail faces towards the wall.**
    - i. To ensure the screw head secures bracket to the wall as shown.
3. Slide rail through the top bracket, and install bottom bracket to wall.
  - a. Longer screws maybe required depending on finished wall thickness. (Not supplied.)
  - b. Silicone sealant is recommended to seal the bracket.

### Install Wall Elbow

1. Install wall elbow with 15mm parallel thread (Not supplied) .
  - a. Ensure O-ring seal is in place.
  - b. Additional sealant maybe required for uneven surfaces.

### Install Hose And Hand Shower:

1. Hand tighten handset to tapered end of hose and ensure seal washer is in place.
2. Connect nut end of hose to water supply and ensure the sealing washer is in place and lightly nip up with a spanner.